

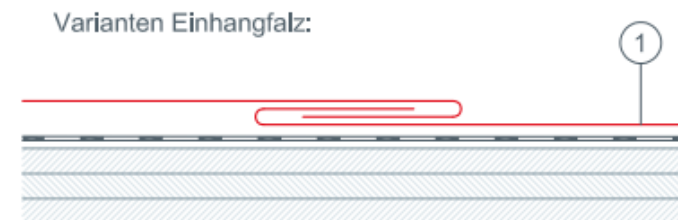

**DAS DACH,  
STARK WIE EIN STIER!**

# STOSSAUSBILDUNG BEI ATTIKA

## CAD-DETAILS

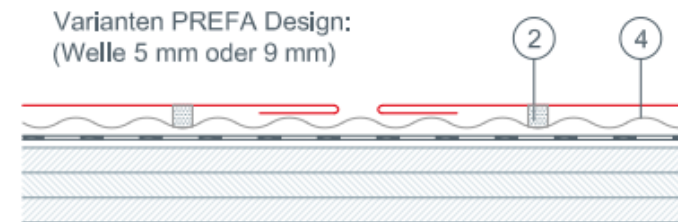
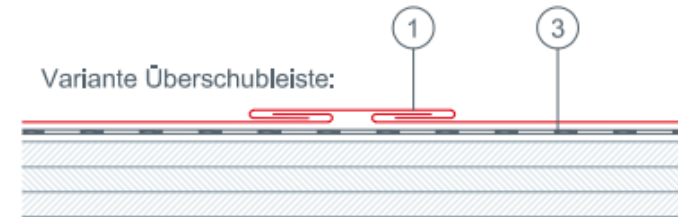
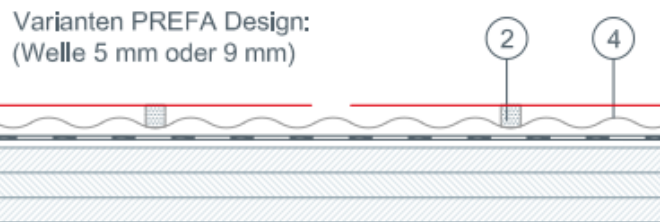
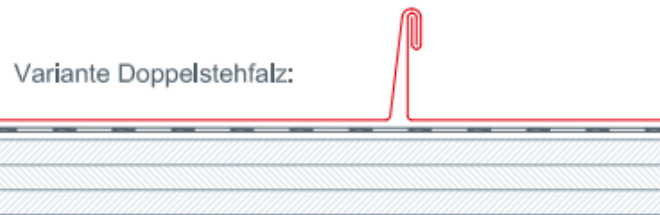

- ① ... Varianten Stossausbildung
- ② ... ev. Dichtmittel (Falzgel)
- ③ ... ev. Trennlage
- ④ ... PREFA Design (Welle 5 mm oder 9 mm)